

Handling System for Rack Type Basket Cord Conveyor, Drive Unit - Left to Right, 400mm

ITEM # _____

MODEL # _____

NAME # _____

SIS # _____

AIA # _____

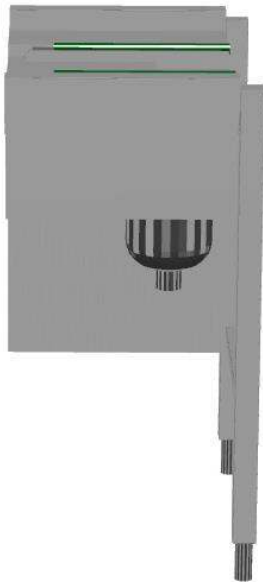
863167 (HSBCCDULR4)

Drive Unit of cord conveyor for baskets, Left>Right operation

Short Form Specification

Item No. _____

Constructed in 304 AISI stainless steel. Square 40x40mm tubular legs on height adjustable feet. Variable speed controlled by the dishwasher. Emergency stop button. Designed to be connected with rack type dishwasher using 500x500mm baskets. Feed direction left to right.

Main Features

- Range built in modules to allow a large number of conveyor combinations.
- Available as optional accessory a remote easy-to reach emergency-stop buttons fitted where required.
- Drive Unit can sustain up to 10 m; for longer distances Central Units are needed.
- "Key holes" and "snap on" system reduces the number of screws needed for fast and easy installation.
- Main electrical controls protected by a water-resistant stainless steel box.
- Designed to be connected with rack type dishwasher.
- The unit is part of the complete motorized handling system which can be installed either on loading and/ or unloading sides providing automatic loading and unloading the baskets for better ergonomic operation.
- The Drive Unit has 3 different variable speeds controlled by rack type dishwasher.
- Cord conveyor system generates smooth basket movement and improves hygiene.

Construction

- All surfaces smooth with polished finish.
- 40x40mm stainless steel tubular and square legs.
- Thick welded flanges for sturdy connection between the units.
- 15mm reinforced polyurethane cord, for smooth and easy running.
- Designed for 500x500mm baskets.
- 304 AISI stainless steel construction throughout.
- Delivered with legs.

Optional Accessories

- 10 m connection cable for drive unit of cord conveyor for baskets PNC 863169
- 10 m cord for cord conveyor (mandatory - to be ordered according to the length of the complete layout) PNC 863170
- 30 m cord for cord conveyor (mandatory - to be ordered according to the length of the complete layout) PNC 863171
- 50 m cord for cord conveyor (mandatory - to be ordered according to the length of the complete layout) PNC 863172
- End limit switch for cord conveyor for basket PNC 863174
- Kit for cord welding PNC 865143
- Emergency stop kit for Rack Type Dishwasher (not for Basic handling system) PNC 865162
- Connection plate (short) for left side to connect handling system to hood type PNC 865163
- Connection plate (long) for front and right side to connect handling system to hood type PNC 865164
- Connection plate - handling to WT90/RT10 PNC 865165

APPROVAL: _____



- Kit electronic connection for motorized table and remote pre-wash module PNC 865290
- Kit electronic connection for motorized table and remote pre wash module for Dual Rinse Rack Type Dishwasher PNC 865508



Front

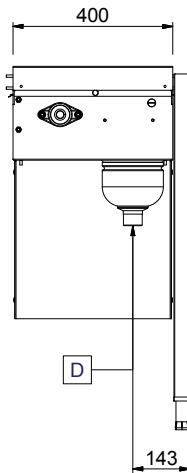

Electric

Electrical power, max: 0.3 kW

Key Information:

Feeding direction: from Left to Right

External dimensions, Width: 400 mm

External dimensions, Depth: 620 mm

External dimensions, Height: 910 mm

Net weight: 40 kg

Basin material: Stainless Steel AISI 304 - EN 1.4301

Feeding motors number: 1

Number of speeds: Variable

Max. speed: 3 m/min

Min. speed - m/min: 0.6 m/min

Side

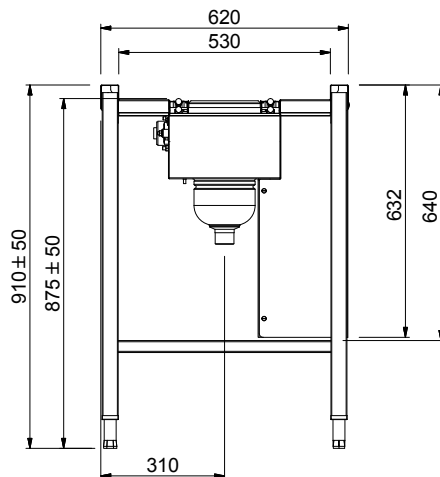

D = Drain
 EI = Electrical inlet (power)

Top

